

WEANTINOGE HERITAGE LAND TRUST

Alice McCallister Memorial Sanctuary, Kent, 64 ac

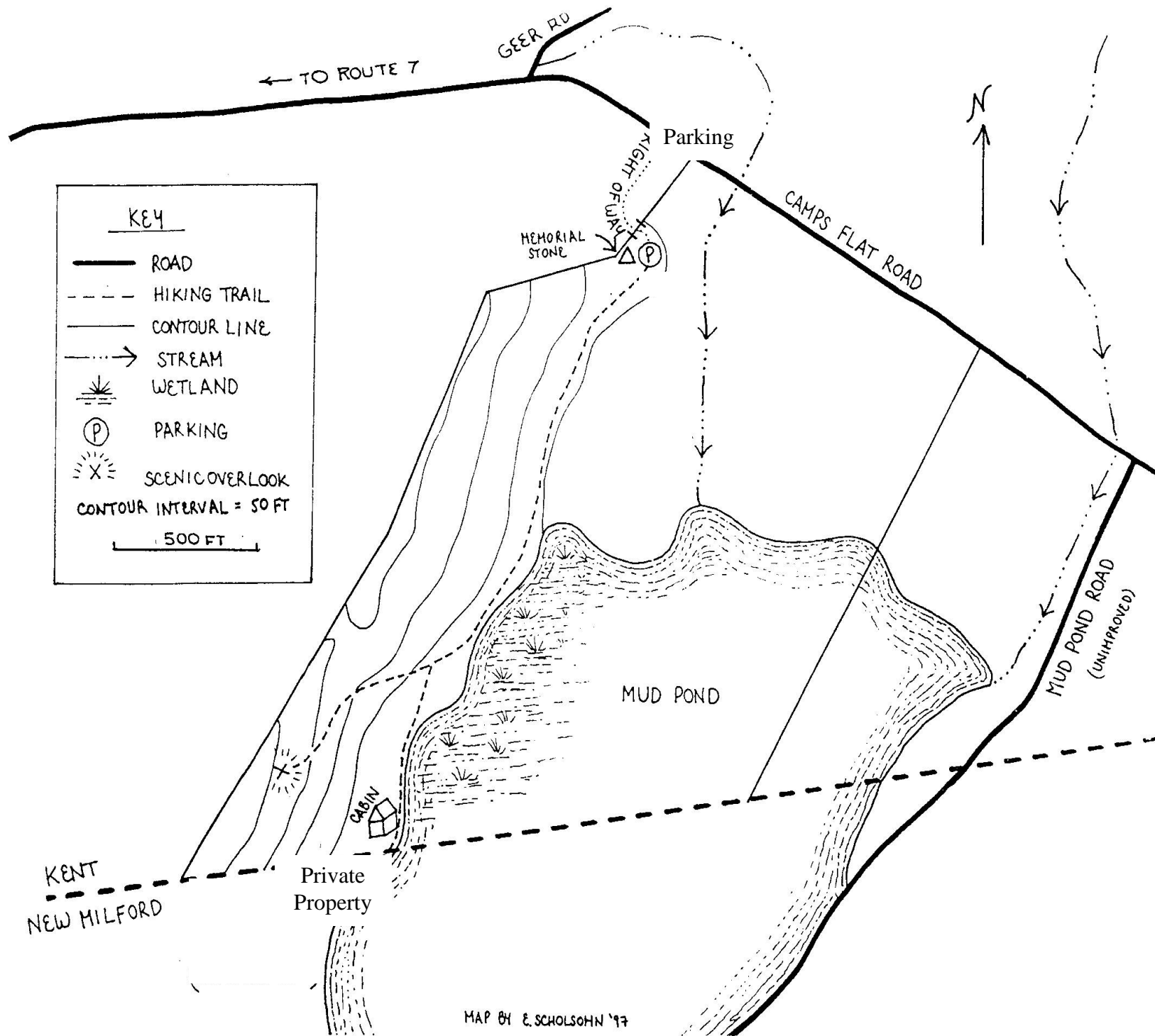

OVERVIEW: Easy walking. Parking to overlook ~ 1 mile. Camping and vehicles are prohibited.

HIGHLIGHTS: As early as the mid-1970's, Weantinoge's founding president, Alice McCallister, identified Mud Pond as a protection priority. Between 1991 and 1995 several people worked hard to purchase the land which had been designed as an 8-lot subdivision. Its purchase was made possible with funds from many private contributors, a generous gift from the Ellen Knowles Harcourt Fund, and funds from the Iroquois Gas Transmission System Land Preservation and Enhancement Program.

Despite its name, Mud Pond is a jewel set between a quartzite ridge on the west and Tory Mountain to the east. There are several types of calcareous (calcium-rich or limy) wetlands along the Pond and well-drained acidic soils on the quartzite ridge. The Sanctuary has an amazing diversity of bird and plant species including Connecticut's largest black ash trees. It will take years to find most of the species...some rare.

CONTACTS: As with a visit to any Weantinoge preserve, if you have questions or concerns, please do not hesitate to call the Weantinoge office at (860) 927-1927 or email us at info@weantinoge.org.

SUPPORT LOCAL CONSERVATION:

Become a member or volunteer today and support your local land, water, and wildlife conservation. For more information, please visit our website at www.weantinoge.org. We look forward to hearing from you!

